

Excel

Series
Excel

Product
Sconce

Dimensions
H 12.5in/32cm x W 24in/60cm x
D 11in/28cm

Weight
9lb/4kg

Sconce

Materials
Walnut, steel

Colors
Black, white, red

Backplate
12 x 16-inch rectangle in walnut

Certifications
UL, cUL (120V) CE, CB (240V)

120V Illumination
Socket: E26

Bulb: 2 x 60 watt A19 incandescent
 Wattage: 120 Watts
 Lumens: (black/red) 340 Lumens,
 (white) 560 Lumens
 Color Temperature: 2700 Kelvin
 Dimming: Triac or ELV

240V Illumination
Socket: E27

Bulb: 2 x 60 watt A19 incandescent
 Wattage: 120 Watts
 Lumens: (black/red) 340 Lumens,
 (white) 560 Lumens
 Color Temperature: 2700 Kelvin
 Dimming: Triac or ELV

LED Alternative
Socket: E26/E27

Bulb: 2 x 6 Watt A19 frosted LED
 Wattage: 12 Watts
 Lumens: (black/red) 400 Lumens,
 (white) 680 Lumens
 Color Temperature: 2700 Kelvin
 Dimming: ELV

CONTENTS

Sconce

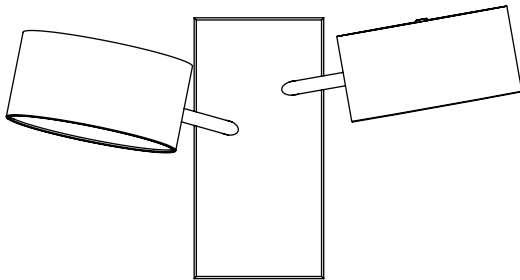

Crossbar



Screws (7)



Allen Key



Top Diffuser

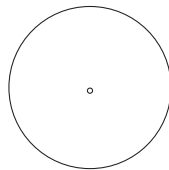

Wire Nuts (2)



Finial Cap



Shade Bracket

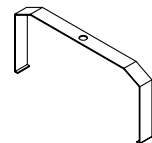

SAFETY INFORMATION

Only one light bulb per socket.

Only suitable for direct mounting on non-combustible surfaces.

Under no circumstances can Excel fixtures be mounted on normally flammable surfaces.

Suitable for dry, indoor use only.

Maximum ambient temperature: 25° C

EXCEL SCONCE INSTALLATION

Note: Please contact a licensed electrician.
Note: Do not use bulbs that exceed 60 watts.

1. Connect the wires using wire nuts (A).
2. Install the crossbar (B) and affix the ground strap with the ground screw (C).
3. Affix Crossbar (B) to junction box with screws (D).
4. Register wooden sconce backplate (E) to crossbar (B) and secure with screws (F).
5. Install light bulbs (G) Light bulbs provided by customer.
6. Place bracket (H) onto existing shade bracket so that both form a cross.
7. Place metal diffuser (I) on top of brackets and affix by screwing down cap finial (J).

