

Counterweight

Series
Counterweight

Product
Sconce

Dimensions
H 18in/46cm x W 5in/12cm x
D 4in/10cm

Weight
3lb/1.4kg

Sconce

Materials
Wood, brass, Carrera marble, glass

Finishes
Ash/brass, walnut/brass

Backplate
7.5 x 5-inch rectangle in Carrera marble

Certifications
UL, cUL (120V)

120V Illumination
Integrated LED
Wattage: 15 Watts
Lumens: 1350 Lumens
Color Temperature: 2700 Kelvin
Life Hours: 50,000
Dimming: ELV

240V Illumination
Integrated LED
Wattage: 15 Watts
Lumens: 1350 Lumens
Color Temperature: 2700 Kelvin
Life Hours: 50,000
Dimming: ELV or 0-10V

CONTENTS

Counterweight Sconce

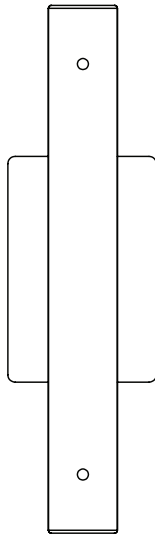

Glass Shade

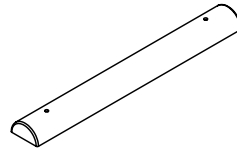

Custom Crossbar

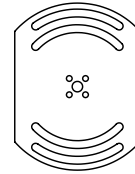

8-32 Thumb screws (2)



8-32 long screws (2)



8-32 Crossbar Screws (2)



SAFETY INFORMATION

Only suitable for direct mounting on non-combustible surfaces.

Under no circumstances can Counterweight Fixtures be mounted on normally flammable surfaces.

Suitable for dry, indoor use only.

Maximum ambient temperatures: 25° C

SCONCE INSTALLATION

*Note: Please contact a licensed electrician.
Note: Do not use bulbs that exceed 60 watts.*

1. Pull the leads from the fixture through the custom crossbar.
2. Join the leads from the fixture to the leads from the wall in the junction box with wire nuts. Stuff the excess cord into the junction box.
3. Attach the custom crossbar to the junction box with the provided 8-32 screws.
4. Align the fixture with the holes of crossbar. Thread the two long 8-32 screws through the center of the fixture into the two threaded holes of the custom crossbar.
5. Make adjustments to the crossbar when necessary to make the fixture level.

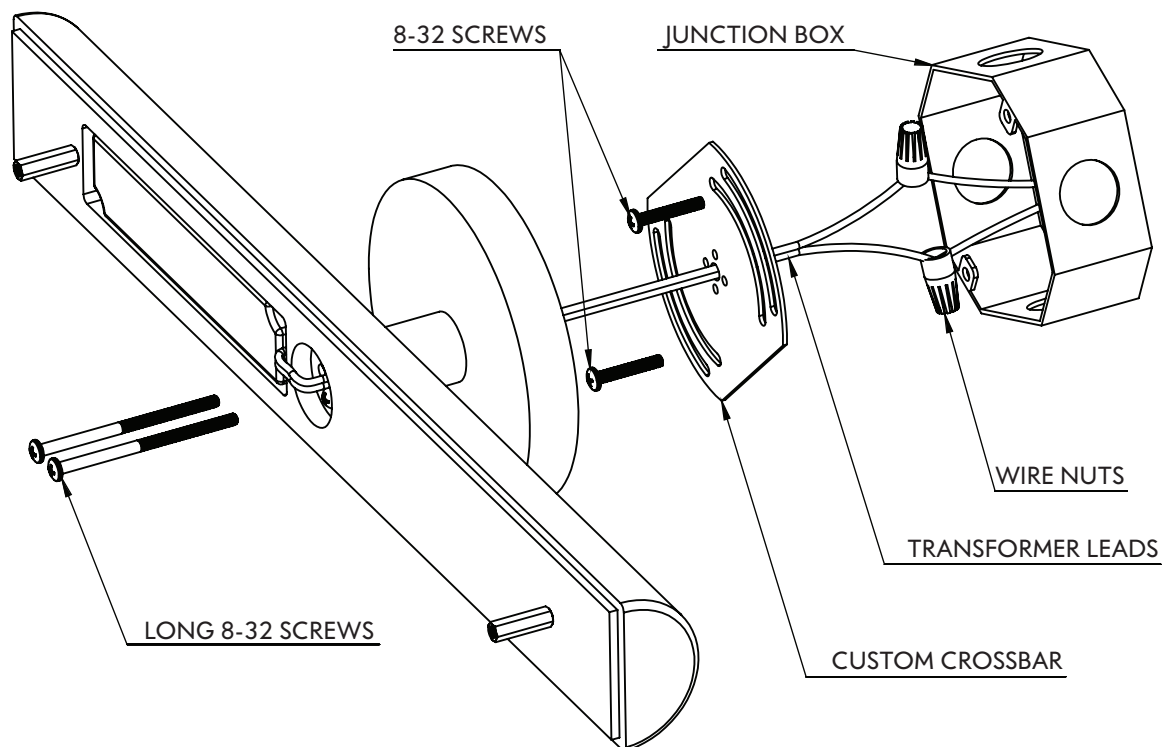

GLASS ASSEMBLY

1. Position the holes of the glass over the holes of the standoffs on the fixture.
2. Screw in the 8-32 thumb screws until the glass is firmly pressed against the wood. Do not over tighten, or the glass will have a chance of breaking.

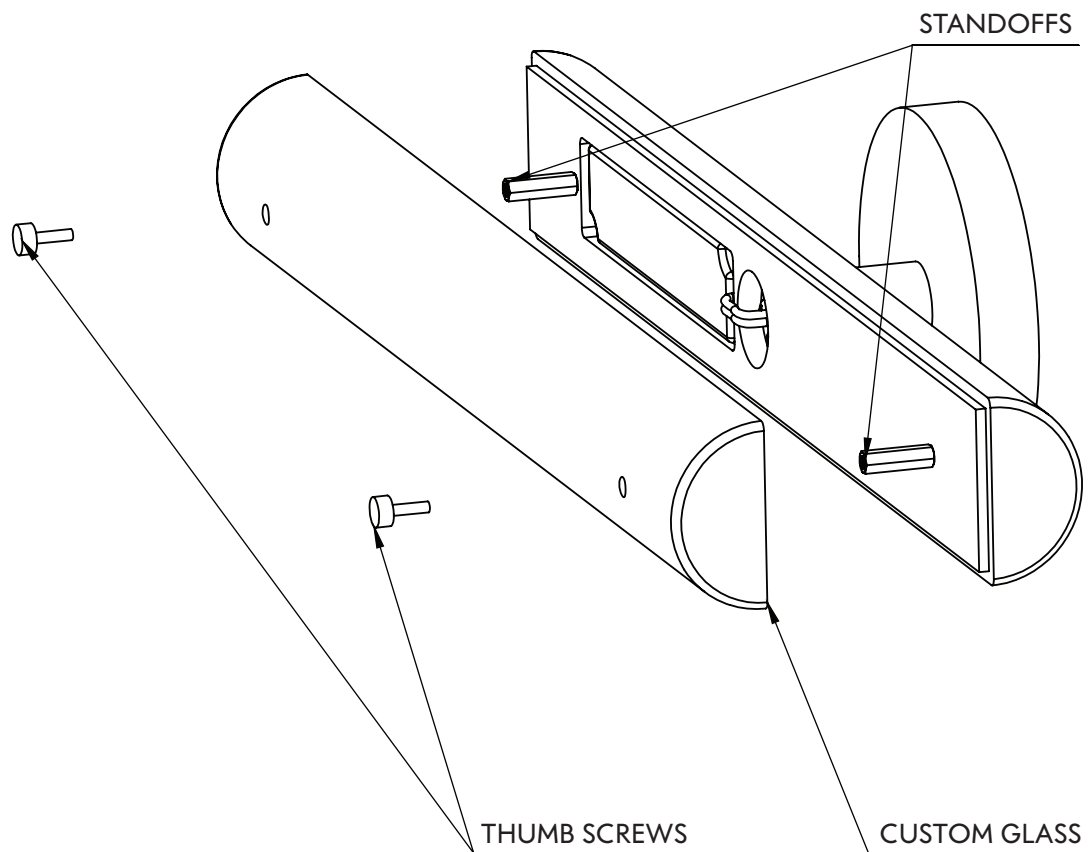

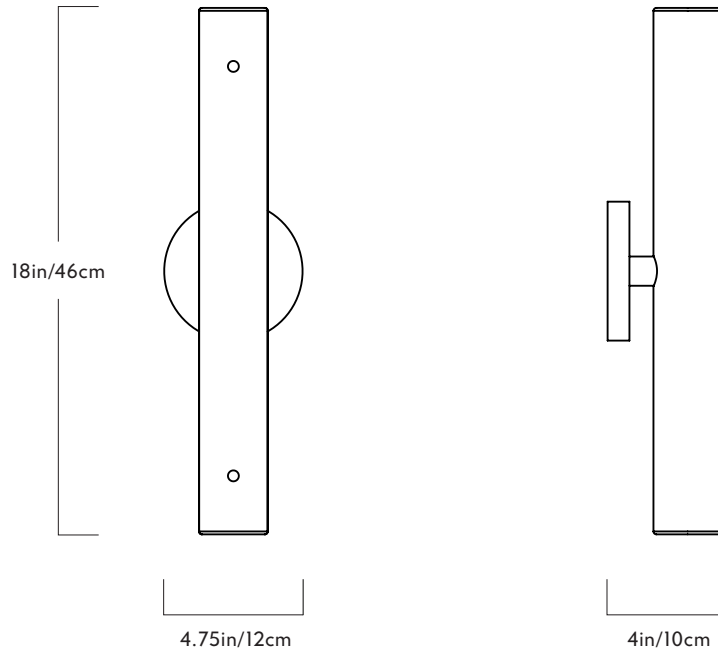

Counterweight

Series
Counterweight

Product
Circle Sconce

Dimensions
H 18in/46cm x W 5in/12cm x D
4in/10cm

Weight
2lb/.9kg

Circle Sconce

Materials
Wood, brass, Carrera marble, glass

Finishes
Ash/brass, walnut/brass

Backplate
4.75 inch circle in Carrera marble

Certifications
UL, cUL (120V)

120V Illumination
Integrated LED
Wattage: 15 Watts
Lumens: 1350 Lumens
Color Temperature: 2700 Kelvin
Life Hours: 50,000
Dimming: ELV

240V Illumination
Integrated LED
Wattage: 15 Watts
Lumens: 1350 Lumens
Color Temperature: 2700 Kelvin
Life Hours: 50,000
Dimming: ELV or 0-10V

CONTENTS

Counterweight Circle Sconce

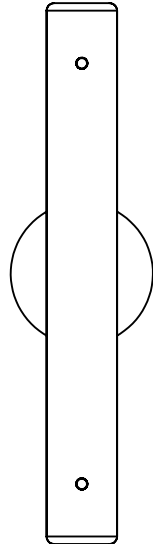

Glass Shade

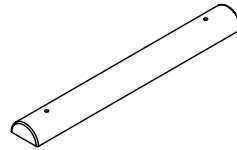

Custom Crossbar

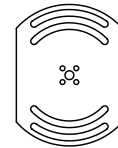

8-32 Thumb screws (2)



8-32 long screws (2)



8-32 Crossbar Screws (2)



Wire connectors (2)



SAFETY INFORMATION

Only suitable for direct mounting on non-combustible surfaces.
Under no circumstances can Counterweight Fixtures be mounted on normally flammable surfaces.
Suitable for dry, indoor use only.
Maximum ambient temperatures: 25° C

COUNTERWEIGHT SCONCE INSTALLATION

Note: Please contact a licensed electrician.

1. Pull the LED leads from the fixture through the custom crossbar.
 2. Connect LED leads to 120V driver with wire connectors. Connect 120V leads and place driver into the junction box. Push the excess cord into the junction box.
 3. Attach the custom crossbar to the junction box with provided 8-32 machine screws. Make sure that the four center holes are aligned vertically and horizontally.
 4. Align the fixture with the holes of the crossbar. Thread the two long 8-32 screws through the center of the fixture into the two threaded holes of the custom crossbar.
 5. Make adjustments to the crossbar when necessary to make the fixture level.
-

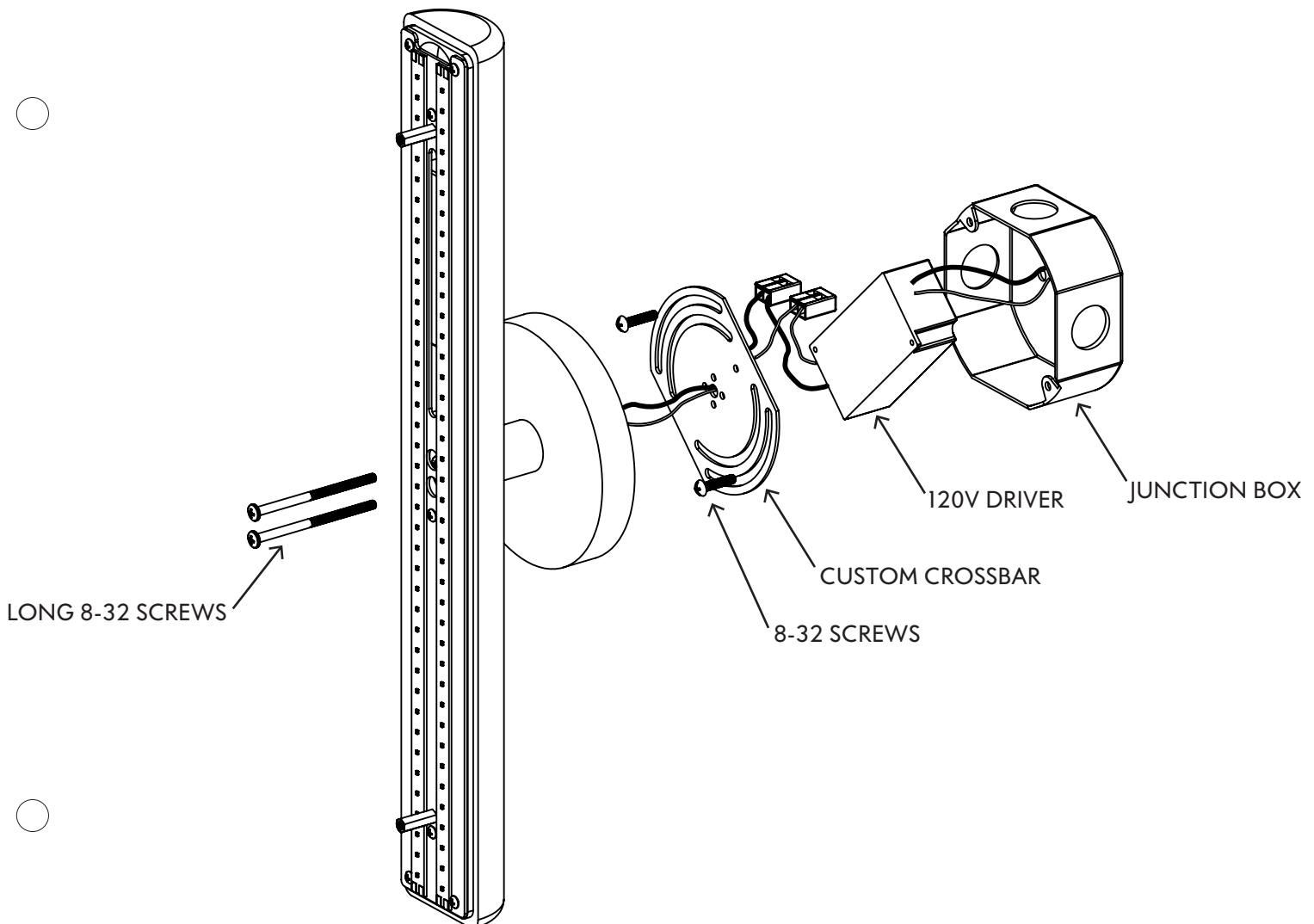

COUNTERWEIGHT SCONCE INSTALLATION

Glass Assembly

1. Position the holes of the glass over the holes of the standoffs on the fixture.
2. Screw the 8/32 thumb screws until the glass is firmly pressed against the wood. Do not overtighten or the glass may break.

